

Zinc CR3 Plated Steel | A2 & A4 Stainless Steel | Brass

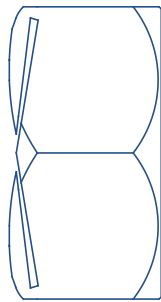
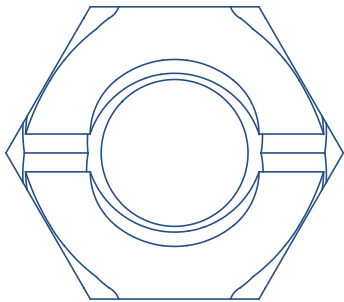

Dimensions

Thread Size	M3 x 0.50	M4 x 0.70	M5 x 0.80	M6 x 1.00	M8 x 1.25	M10 x 1.50	M12 x 1.75	M14 x 2.00	M16 x 2.00	M18 x 2.50	M20 x 2.50	M22 x 2.50	M24 x 3.00	M30 x 3.50
A/F	5.5	7	8	10	13	17	19	22	24	27	30	32	36	46
Height	3.2	3.2	4.05	6	6.35	7.85	9.9	10.9	12.95	15	16	17.8	18.8	23.9

Performance Data: Coarse Threads Grade 5

Thread	M3 x 0.50	M4 x 0.70	M5 x 0.80	M6 x 1.00	M8 x 1.25	M10 x 1.50	M12 x 1.75	M14 x 2.00	M16 x 2.00	M18 x 2.50	M20 x 2.50	M22 x 2.50	M24 x 3.00	M30 x 3.50	
Proof Load (N)	2,600	4,550	8,250	11,700	21,600	34,200	51,400	70,200	95,800	121,000	154,400	190,900	222,400	353,400	
Prevailing Torque (Nm)	First Assy (max)	0.43	0.9	1.6	3.0	6.0	10.5	15.5	24.0	32.0	42.0	54.0	68.0	80.0	108.0
	First Removal (min)	0.12	0.18	0.29	0.45	0.85	1.5	2.3	3.3	4.5	6	7.5	9.5	11.5	16
	Fifth Removal (min)	0.08	0.12	0.2	0.3	0.6	1	1.6	2.3	3	4.2	5.3	6.5	8	12
Tightening Torque (Nm)	Min	0.7	1.6	3.2	5.4	13.3	26.4	46	73	115	158	224	303	388	456
	Max	1.1	2.4	4.8	8.1	20	39.6	69	110	173	238	336	454	582	684

Performance Data: Stainless Steel

Thread	M4 x 0.70	M5 x 0.80	M6 x 1.00	M8 x 1.25	M10 x 1.50	M12 x 1.75	M14 x 2.00	M16 x 2.00	
Prevailing Torque (Nm)	First Assy	0.25	0.29	TBA	1.24	2.36	4.69	5.27	9.95
	First Removal (min)	0.2	0.2	TBA	1.23	1.91	3.73	4.18	7.05
	Fifth Removal (min)	0.16	0.2	TBA	0.98	1.7	2.56	2.78	6.21
Tightening Torque (Nm)	4.58	10.53	15.90	39.70	120.00	160.00	200.00	240.00	

All data is correct to the best of our knowledge, however TR cannot be held responsible for any errors or omissions. For full technical data visit www.trfastenings.com

Contact us:
Info@trfastenings.com
sales@trfastenings.com